

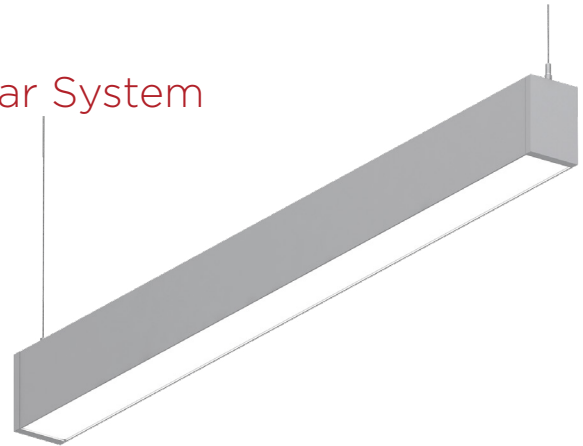

# R Series - 3RSS/4RSS

## 3" and 4" Suspended Direct Lighting Linear System



OVERVIEW	
Lumen Range	600 - 1,300
CCT	2700K, 3000K, 3500K, 4000K, 5000K
Wattage Range	22 - 48
Efficacy Range (LPW)	107 -118
Weight lbs (kg)	3 lbs/ft (1.3 kg/ft)

### QUICK LINKS

[Ordering Guide](#)[Performance](#)[Dimensions](#)

### FEATURES & SPECIFICATIONS

#### Construction

- Rigid extruded aluminum housing for consistency and strength
- Die Cast Aluminum End Caps
- Available in varying lengths from 2' to 8' for individual or continuous row mounting
- Seamlessly create a variety of shapes with straight and corner units
- Housing is treated with phosphate rust inhibitor and painted with textured powder coat paint.
- Manufactured in the USA

#### Optical System

- High transmission snap-in impact resistant diffuse acrylic lens
- Minimum CRI of 82
- RSS is direct light only
- For additional indirect lighting please refer to RDI model

#### Electrical

- High-performance driver features over-voltage, under-voltage, short-circuit and over temperature protection.
- 0-10V dimming (1% - 100%) standard.
- Standard Universal Voltage (120-277 Vac) Input 50/60 Hz or optional High voltage (347 Vac).
- L70 Calculated Life: >100k Hours (See Lumen Maintenance on Page 2)

- Total harmonic distortion: <20%
- Operating temperature: - -40°C to +40°C (-40°F to +104°F)
- Power factor: >.95
- Input power stays constant over life.
- Factory pre-wired to section ends with quick-wire connectors
- Optional 120-277V 12W integral emergency battery pack is available to meet critical life-safety lighting requirements. The 90-minute batteries provide constant power to the LED system, ensuring code compliance. A test switch/indicator button is installed beneath the snap in lens mounted to the reflector.

#### Controls

- Optional integral passive infrared occupancy sensor available
- Optional integral daylight harvesting sensor available

#### Installation

- Quick connect harness to attach fixtures in continuous rows
- Hanger bracket to provide hanging support between fixtures
- Alignment guides to ensure proper alignment from fixture to fixture
- Power access on top of fixtures
- Single point adjustable length 1/16" diameter cable for mounting to suspended or hard ceilings

- Stem mounting option available
- 5" diameter powder coated steel canopy for power feed locations
- 2" diameter powder coated steel canopy for non-feed locations

#### Warranty

- Complete warranty terms located at: <https://www.lsi-industries.com/resources/terms-and-warranty.aspx>.
- 1 Year warranty on optional Battery Backup. Test regularly in accordance with local codes.

#### Listings

- List for UL 1598 and UL 8750
- RoHS Compliant
- Suitable for damp locations
- Meets Buy American Act requirements
- State of California Title 24 compliant
- DLC qualified product. Not all versions of this product may be DLC qualified. Please check the DLC Qualified Products List at [www.designlights.org/QPL](http://www.designlights.org/QPL) to confirm which versions are qualified.
- Made In USA





## ORDERING GUIDE

[Back to Quick Links](#)

TYPICAL ORDER EXAMPLE: **3RSS 4 LED 06L LF UE 40 WHT**

Prefix	Length	LED Technology	Direct Lumens (Per Foot)	Lens	Voltage	Color Temperature	Fixture Color	Options
<b>3RSS</b> - 3" Width Direct	2 - 2' Length <sup>1</sup> 3 - 3' Length	<b>LED</b>	<b>06L</b> - 600 Lumens <b>10L</b> - 1,000 Lumens <b>11L</b> - 1,100 Lumens <b>13L</b> - 1,300 Lumens	<b>LF</b> - Frosted Diffuse	<b>UE</b> - Universal Voltage (120V-277V)	<b>27</b> - 2700K <sup>2</sup> <b>30</b> - 3000K <b>35</b> - 3500K <b>40</b> - 4000K <b>50</b> - 5000K <sup>2</sup>	<b>WHT</b> - White <b>BLK</b> - Black <b>MSV</b> - Silver <b>RAL</b> - Custom Color (specify i.e. RAL829)	<b>OCC</b> - Occupancy Sensor <b>DAY</b> - Daylight Sensor <b>DOC</b> - Daylight and Occupancy Sensor <b>EM</b> - Emergency Battery Pack <sup>3</sup> <b>EC</b> - Emergency Circuit <sup>3</sup> <b>EH</b> - Emergency Through Harness <sup>4</sup> <b>F</b> - Fast Blow Fuse <b>GMF</b> - Slow Blow Fuse
<b>4RSS</b> - 4" Width Direct	4 - 4' Length 5 - 5' Length 6 - 6' Length 7 - 7' Length 8 - 8' Length <b>CHO</b> - Horizontal 2'x2' Corner							

### Example of a typical fixture application with hardware

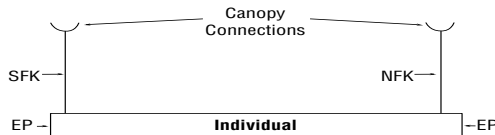

- Includes:**
- Fixture
  - Feed Kit (SFK)
  - Non-Feed Kit (NFK)
  - End Plate Kit (EP - Contains 2)

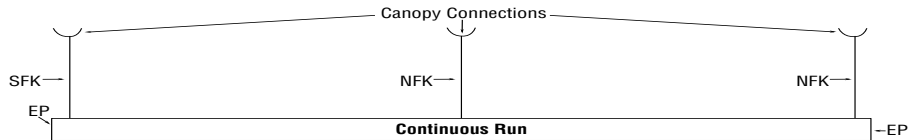

- Includes:**
- Fixtures
  - Feed Kit (SFK)
  - Non-Feed Kit (NFK)
  - End Plate Kit (EP - Contains 2)

## ACCESSORY TABLE

TYPICAL ORDER EXAMPLE: **SFK SP SC 9C FA 36 UE W W**

Prefix	Fixture Attachment	Feed Cord	Ceiling Attachment	Cable Suspension Type	Cable Suspension Length	Stem Length
<b>SFK</b> - Starter Feed Kit	<b>SP</b> - Single Point Cable	<b>SC</b> - Straight	<b>HC</b> - Hard Ceiling	<b>FA</b> - Fully Adjustable	<b>18</b> - 18" Max	12
<b>EFK</b> - Emergency Circuit Feed Kit	<b>S</b> - Stem Mount	<b>Blank</b> - None	<b>1C</b> - 15/16" Tee Clip		<b>24</b> - 24" Max	15
<b>NFK</b> - Non-Feed Kit			<b>9C</b> - 9/16" Tee Clip		<b>36</b> - 36" Max	18
<b>SMP</b> - Stem Power Feed Kit			<b>SC</b> - Screw Slot Clip		<b>72</b> - 72" Max	24
<b>SMNP</b> - Stem Non Feed Kit					<b>144</b> - 144" Max	

Line Voltage	Cord Color	Canopy Color	Dimming
<b>UE</b> - Universal Voltage (120-277V) <b>347</b> - 347V	<b>W</b> - White <b>B</b> - Black	<b>W</b> - White <b>B</b> - Black <b>S</b> - Silver <b>RAL</b> - Custom Color (specify i.e. RAL829)	<b>DIM2</b> - Dimming wires pulled in feed kit <sup>5</sup>

## ENDPLATES

Fixture Series	Width	Description
3RSS - EP	3"	Cable Mount Endplate kit (2 per)
4RSS - EP	4"	Cable Mount Endplate kit (2 per)
3RSS - SEP	3"	Stem Mount Endplate kit (2 per)
4RSS - SEP	4"	Stem Mount Endplate kit (2 per)

### Notes:

- 1 - Sensor options not available for this length
- 2 - Adds 1 week to published lead time
- 3 - Requires EFK Hardware Accessory
- 4 - EH is required if emergency circuit traverses multiple fixtures
- 5 - Only valid with SFK





## PERFORMANCE

[Back to Quick Links](#)

DELIVERED LUMENS - 5000K						
Size	Output	3000K	3500K	4000K	5000K	Wattage
3"	06L	604	613	634	653	5.7
	10L	919	934	965	993	8.7
	11L	1,078	1,095	1,132	1,165	10.4
	13L	1,222	1,242	1,283	1,321	12.0
4"	06L	630	640	662	681	5.7
	10L	962	979	1,010	1,040	8.7
	11L	1,127	1,147	1,184	1,220	10.4
	13L	1,280	1,300	1,344	1,383	12.0

\*LED Chips are frequently updated therefore values are nominal.

ELECTRICAL DATA - PER FOOT*					
Drive Current	120V	208V	240V	277V	347V
06L	0.048A	0.027A	0.024A	0.021A	0.016A
10L	0.073A	0.042A	0.036A	0.031A	0.025A
11L	0.087A	0.050A	0.043A	0.038A	0.030A
13L	0.100A	0.058A	0.050A	0.043A	0.035A

\*Electrical data at 25C (77F). Actual wattage may differ by +/-10%.

RECOMMENDED LUMEN MAINTENANCE					
Ambient	Initial <sup>2</sup>	25K hr <sup>2</sup>	50K hr <sup>2</sup>	75K hr <sup>3</sup>	100K hr <sup>3</sup>
0 C (32 F)	1.02	0.96	0.94	0.92	0.90
5 C (41 F)	1.02	0.96	0.94	0.91	0.89
10 C (50 F)	1.01	0.95	0.92	0.89	0.86
15 C (59 F)	1.01	0.95	0.91	0.87	0.83
20 C (68 F)	1.00	0.94	0.89	0.84	0.80
25 C (77 F)	1.00	0.92	0.86	0.81	0.75
30 C (86 F)	0.99	0.91	0.83	0.77	0.71
35 C (95 F)	0.98	0.91	0.80	0.70	0.62

1 - Lumen maintenance values at 25C are calculated per TM-21 based on LM-80 data and in-situ testing.

2 - In accordance with IESNA TM-21-11, Projected Values represent interpolated value based on time durations that are within six times the IESNA LM-80-08 total test duration for the device under testing.

3 - In accordance with IESNA TM-21-11, Calculated Values represent time durations that exceed six times the IESNA LM-80-08 total test duration for the device under testing.

## PHOTOMETRY

[Back to Quick Links](#)

### 3RSS 4 LED 06L LF XX 40 WHT

Luminaire photometry has been conducted by a NVLAP accredited testing laboratory in accordance with IESNA LM-79-08. As specified by IESNA LM-79-08 the entire luminaire is tested as the source resulting in a luminaire efficiency of 100%.

See <http://www.lsi-industries.com/products/led-lighting-solutions.aspx> for detailed photometric data.

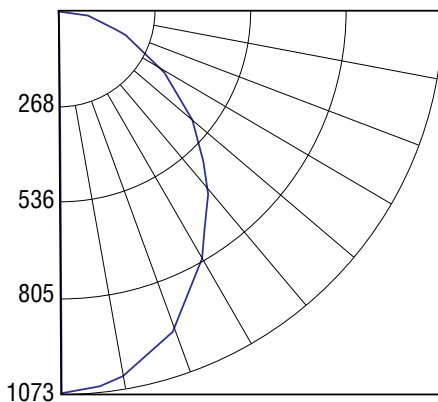

ZONAL LUMEN SUMMARY		
Zone	Lumens	% of Luminaire
0 - 30	781.0	31%
0-40	1,239.3	49.2%
0-60	2,063.3	81.9%
60-90	455.9	18.1%
70-100	184.1	7.3%
90-120	0	0%
0-90	2,519.3	100%
90-180	0	0%
0-180	2,519.3	100%





## PRODUCT DIMENSIONS

[Back to Quick Links](#)

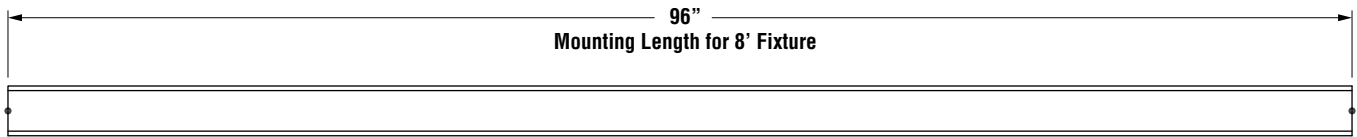
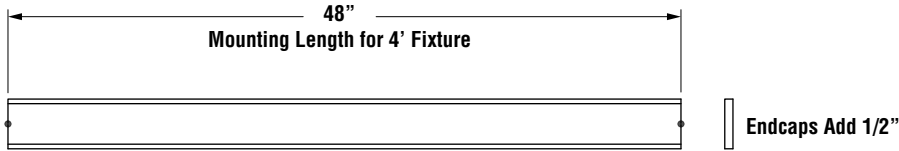

## CORNER DIMENSIONS

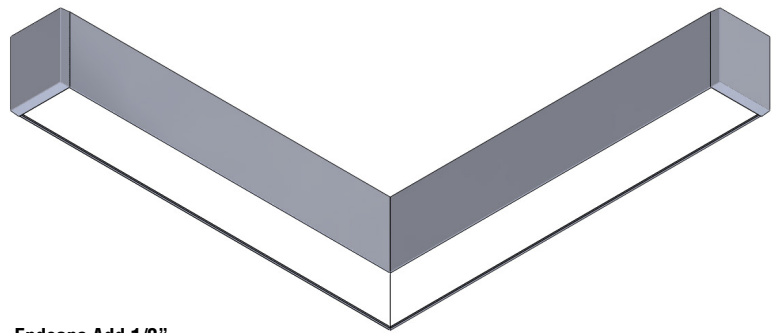
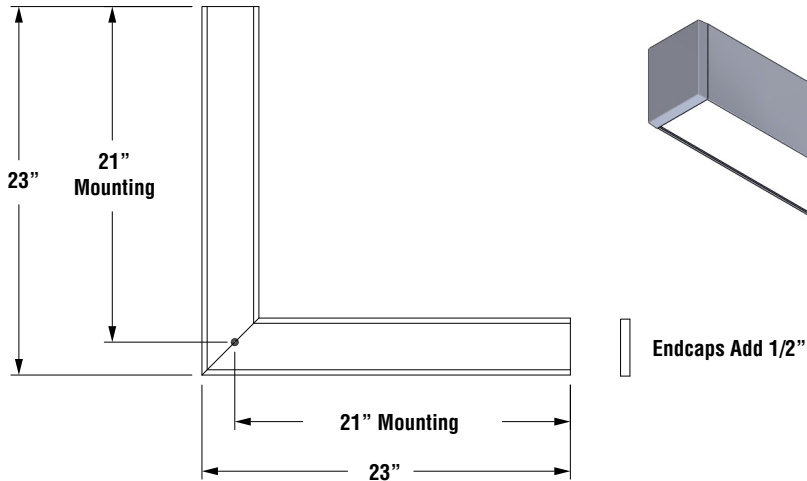

## MOUNTING

9/16" Tee Clip

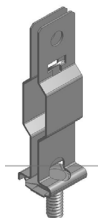

15/16" Tee Clip

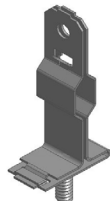

Screw Slot Tee Clip

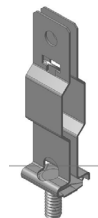

Mounting Strip to J-Box  
(J-Box by Others)

